



Dental Lights



INDEX - DENTAL LIGHTS

Dental light Storus GLX*	
Product description	83
General data Dental light Storus GLX	83
Dental light Persus GL*	
Product description	84
General data Dental light Persus GL	84
Dimensions	85
Technical specifications	87
Operation	87
Adjustments and repairs	88
Diagrams	89
Troubleshooting	90

PRODUCT DESCRIPTION (DENTAL LIGHT STORUS GLX)

Dental light for dental use with a 20.000 and 25.000 Lux intensity, smooth movement, and standard ice color compatible with all environments.

Head made of resistant material, with a rotation of 620°, propitiating lightness, durability, and ample mobility in all positions. Activated by means of a long shaft switch, and may be activated with the back of the hand, optimizing biosafety.

Bilateral handle shaped grips enable isolation preventing the risk of cross contamination.

Multifaceted mirror with multicoating treatment, generating innumerable light sources, avoiding shadows created by interpositions.

Mirror protector in a resistant, transparent material protecting against aerosols.

Arm in steel with vertical and horizontal movement with rounded edges, smooth paintwork for easy aseptic cleaning.

ISO 9001 Quality System, assuring the products are manufactured under standart procedures.

- Products manufactured in agreement with RDC 59 - ANVISA - (Sanitary Surveinllance National Agency) - with guarantees accomplishment to the sanitary legislation according to BPF - (Good Manufacturing Procedures), requested by Mercosul Sanitary authorities.

In order to comply with directive 93/42/EEC for CE Mark purpose, it is defined that the working life of this product is estimated in 10 years provided that the end-user follows the requirements and instructions of this manual.

IMPORTANT:

• If this equipment is for dental use only. It must be operated by authorised personnel following the instructions of this manual. It is required to the user the utilisation of working instruments in perfect conditions and to protect him/herself, patients and others from eventual danger situations.

• If this equipment is throw way, do it in appropriate area.

GENERAL DATA

Dental light Storus GLX

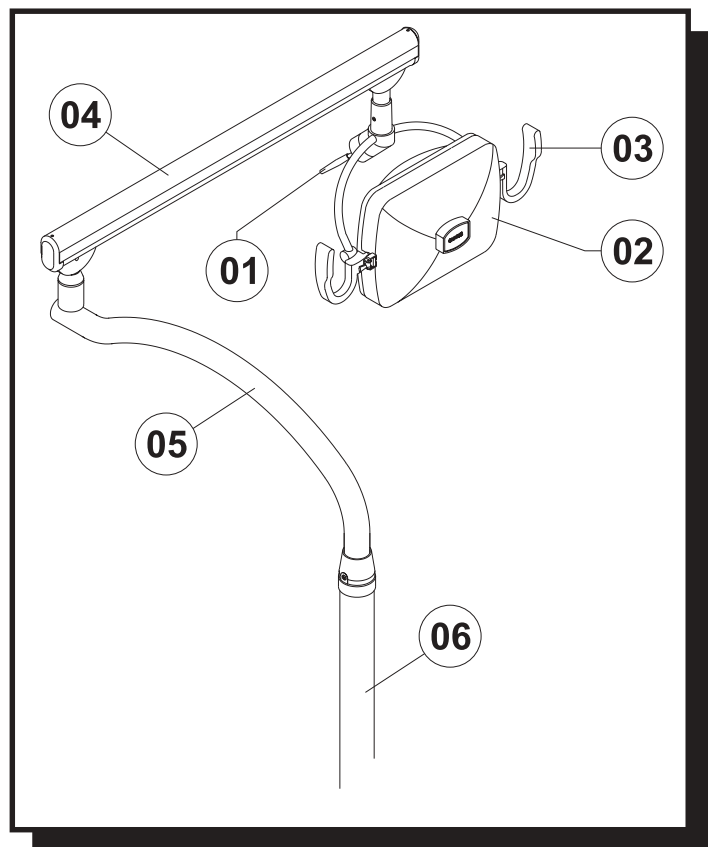

- 01- On/Off switch
- 02 - Protector
- 03 - Handle
- 04 - Articulate arm
- 05 - Column arm
- 06 - Column

PRODUCT DESCRIPTION (DENTAL LIGHT PERSUS GL)

Dental light for dental use with a 15.000 and 20.000 Lux intensity, smooth movement, and standard ice color compatible with all environments.

Head made of resistant material, with a rotation of 620°, propitiating lightness, durability, and ample mobility in all positions. Activated by means of a long shaft switch, and may be activated with the back of the hand, optimizing biosafety.

Bilateral handle shaped grips enable isolation preventing the risk of cross contamination.

Multifaceted mirror with multicoating treatment, generating innumerable light sources, avoiding shadows created by interpositions.

Mirror protector in a resistant, transparent material protecting against aerosols.

Arm in steel with vertical and horizontal movement with rounded edges, smooth paintwork for easy aseptic cleaning.

ISO 9001 Quality System, assuring the products are manufactured under standart procedures.

- Products manufactured in agreement with RDC 59 - ANVISA - (Sanitary Surveinllance National Agency) - with guarantees accomplishment to the sanitary legislation according to BPF - (Good Manufacturing Procedures), requested by Mercosul Sanitary authorities.

In order to comply with directive 93/42/EEC for CE Mark purpose, it is defined that the working life of this product is estimated in 10 years provided that the end-user follows the requirements and instructions of this manual.

IMPORTANT:

• If this equipment is for dental use only. It must be operated by authorised personnel following the instructions of this manual. It is required to the user the utilisation of working instruments in perfect conditions and to protect him/herself, patients and others from eventual danger situations.

• If this equipment is throw way, do it in appropriate area.

GENERAL DATA

Dental light Persus GL

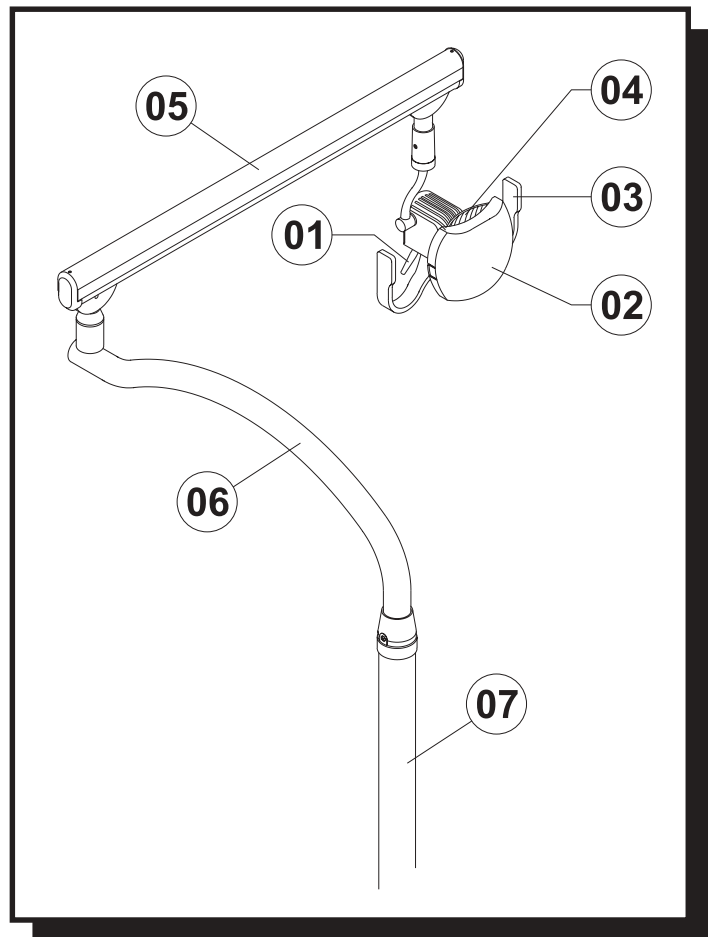

- 01- On/Off switch
- 02 - Protector
- 03 - Handle
- 04 - Articulate arm
- 05 - Column arm
- 06 - Column

DIMENSIONS

(DENTAL LIGHT STORUS GLX)

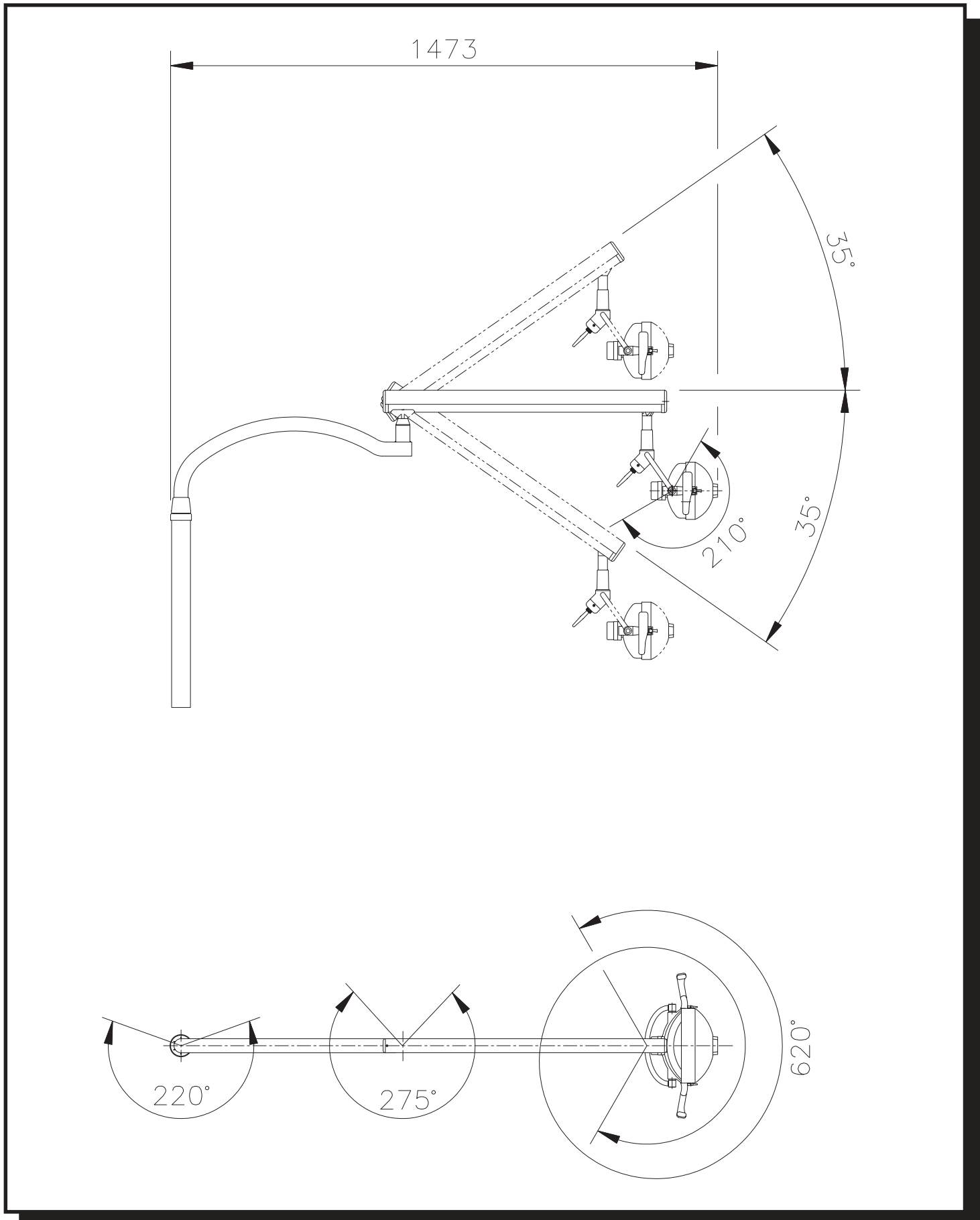

DIMENSIONS

(DENTAL LIGHT PERSUS GL)

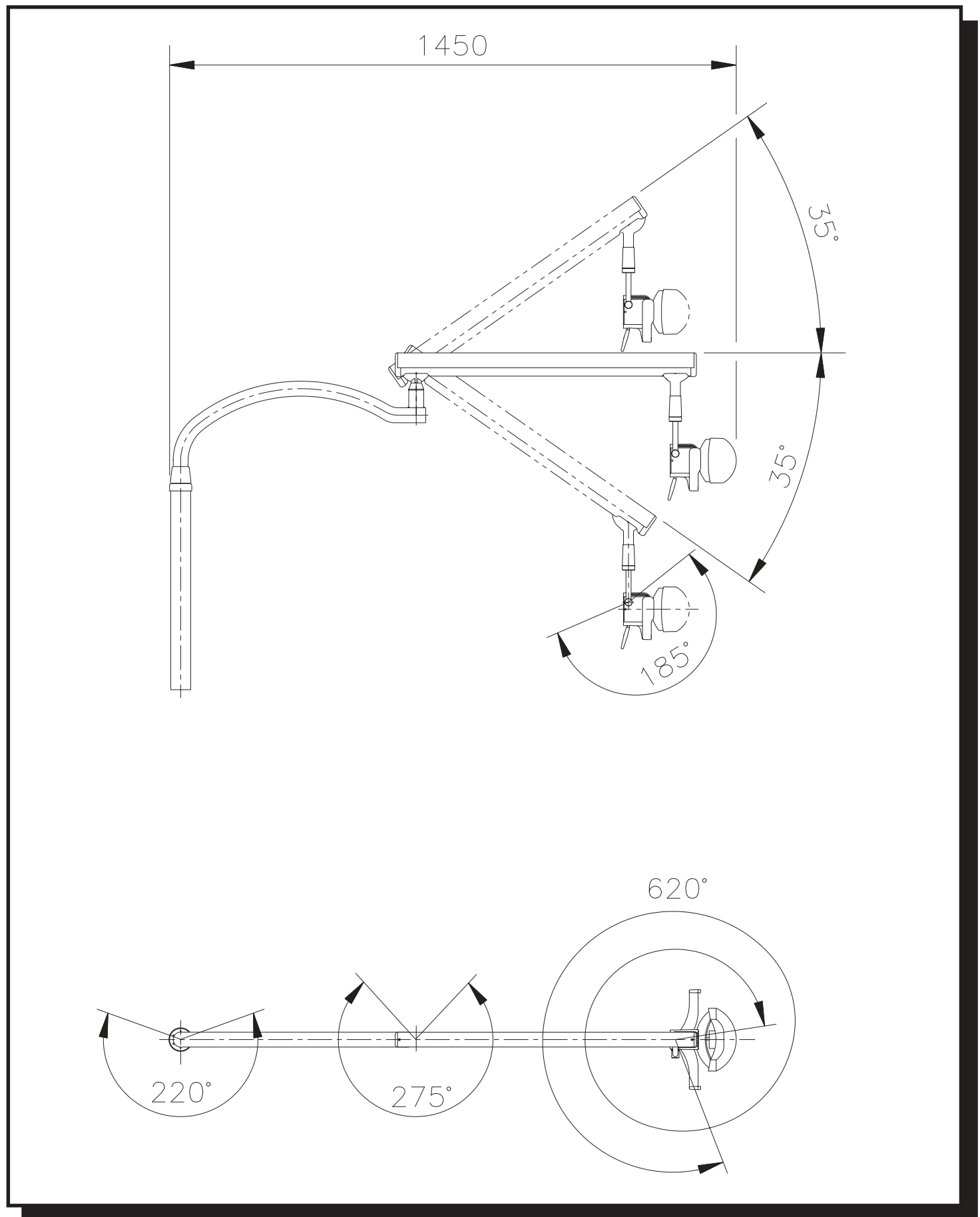

TECHNICAL SPECIFICATIONS

Storus GLX Dental Light

- **Supply voltage**
13,5V~ and 14,5V~ (from the Syncrus Dental Chair)
- **Luminosity**
20.000 / 25.000 LUX

- **Net weight**
9,30 Kg
- **Gross weight**
12,60 Kg

- **Lamp**
HLX 24V 150W
- **Distance between the headstock and the operative field**
70cm

Persus GL Dental Light

- **Supply voltage**
11V~ and 12V~ (from the Syncrus Dental Chair)
- **Luminosity**
20.000 / 25.000 LUX

- **Net weight**
8,70 Kg
- **Gross weight**
12 Kg

- **Lamp**
H3 12V 55W
- **Distance between the headstock and the operative field**
70cm

Product symbols



Warning

Landing (in many parts of the equipment) indicates the condition of being landed.

OPERATION



How to turn on the Dental Light

To turn on the dental light just actuate the on/off key (01).

To turn on the dental light just actuate the on/off key (01).

To alter the brightness of the Storus GLX Dental Light (20.000 or 25.000 Lux), Persus GL Dental Light (20.000 or 15.000 Lux), actuate the buttons locate at the Syncrus Chair pedal (consult the Syncrus Chair Owner's Manual).

Movement of the Headstock

The movement of the headstock is made through the knob (03), totally ergonomic designed to provide absolute isolation.

IMPORTANT:

Position the headstock 70cm of the operative field.

Dental light Storus GLX

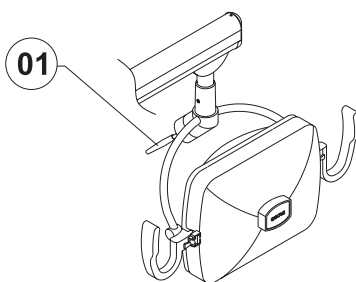

Dental light Persus GL

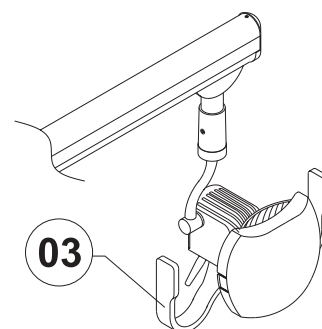
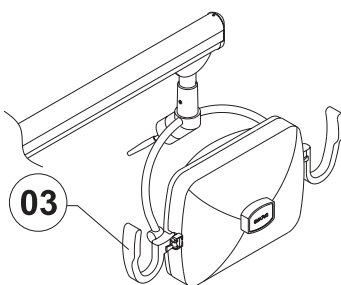
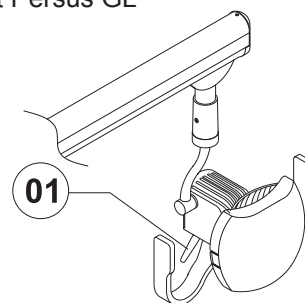

ADJUSTMENTS AND REPAIRS

How to change the reflector light Storus GLX Dental Light

Turn off the general key of the Syncrus Dental Chair or turn off the circuit breaker. Verify if the reflector is cold. Disconnect the tags (07) and take the protector off (02), then change the light (08).

ATTENTION:

Never touch the light bulb with the fingers. Use a handkerchief. In case of physical contact clean the light bulb with alcohol.

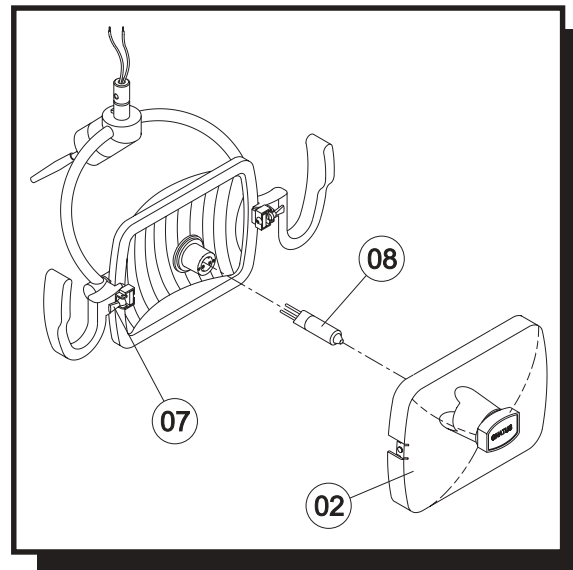

How to change the reflector light - Persus GL Dental Light

- Turn off the general key of the Syncrus dental chair or turn off the circuit breaker;
- Verify if the dental light is cold;
- Remove the protector (02) thru the fixation block (08);
- In an unclockwise job, remove the deflector (09) and pull the lamp out (10) with care, only till locate terminals (11);
- Only after that, disconnect the terminals and substitute the lamp.

ATTENTION:

Never touch the light bulb with the fingers. Use a handkerchief.

Cleansing of the protector

IMPORTANT: The cleansing of the light's protector (02), should only be done using a water-dampened flannel or cotton. Do not use chemicals of any sort, for it may stain the protector.

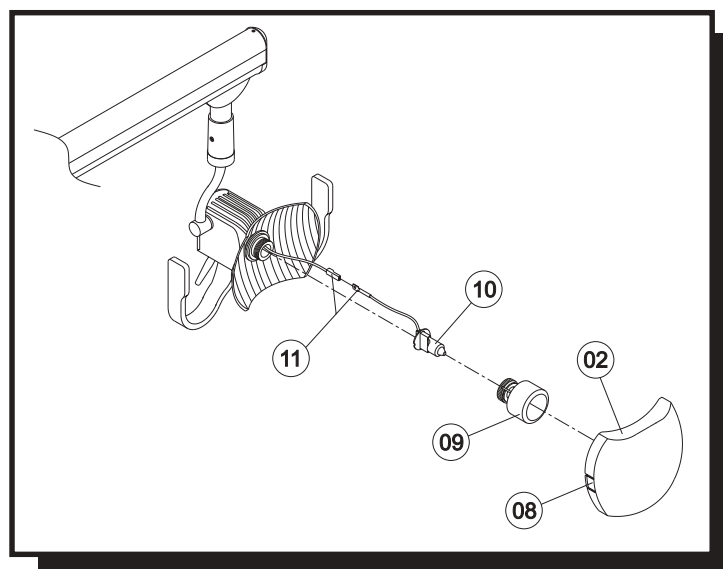

Lamp adjustment

Open the spotlight's rear cover, loosen the screw (01), that locks the lamp's support tube (02), and with the lamp on, move the tube until the desired adjustment is obtained, then fix the tube (02) tightening the screw (01)

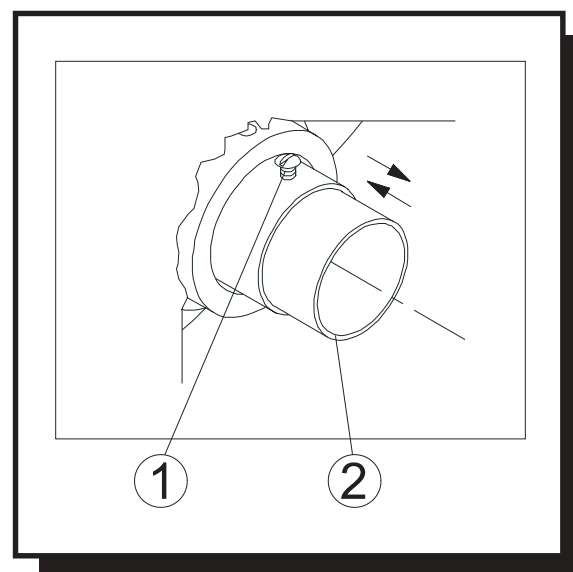

ADJUSTMENTS AND REPAIRS

Balancing the Dental light

Loosen the screws (01) and remove covers (2), take the arm's cover out (03). Using an 3/16" hex key, turn the screw (04) clockwise, in order to compress the spring, or counterclockwise to decompress it.

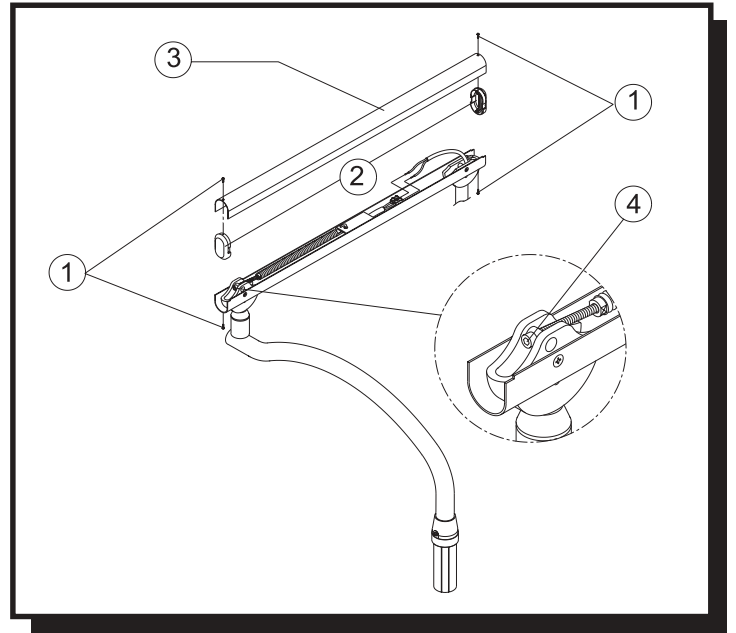

DIAGRAMS

(STORUS GLX DENTAL LIGHT)

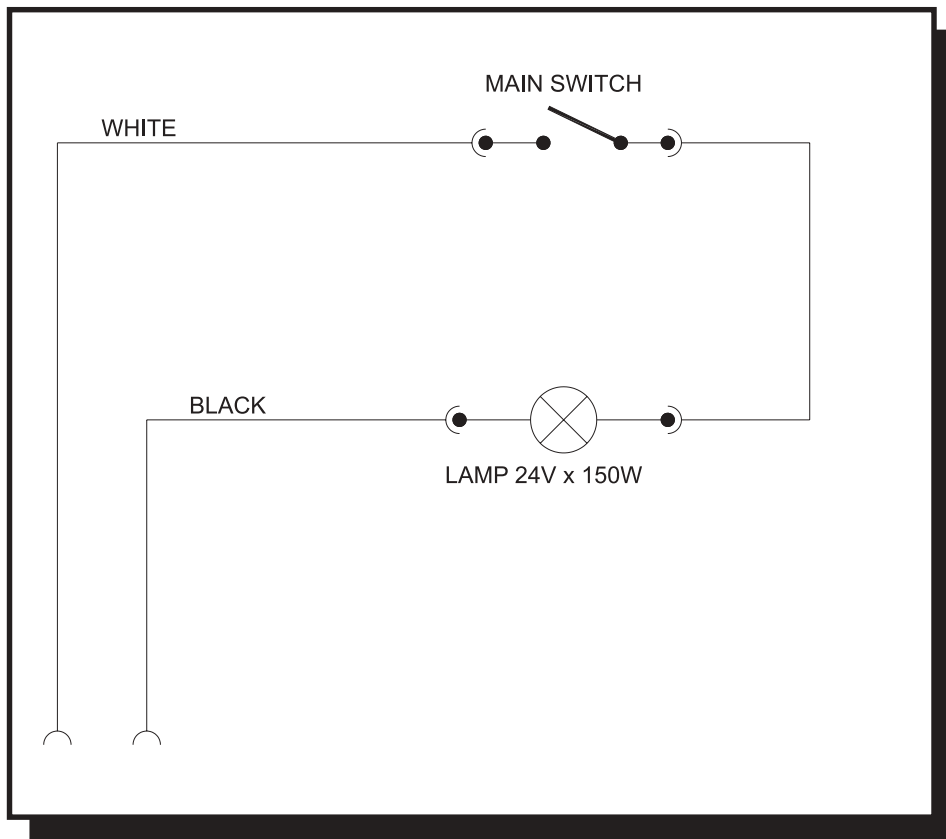

DIAGRAMS

(PERSUS GL DENTAL LIGHT)

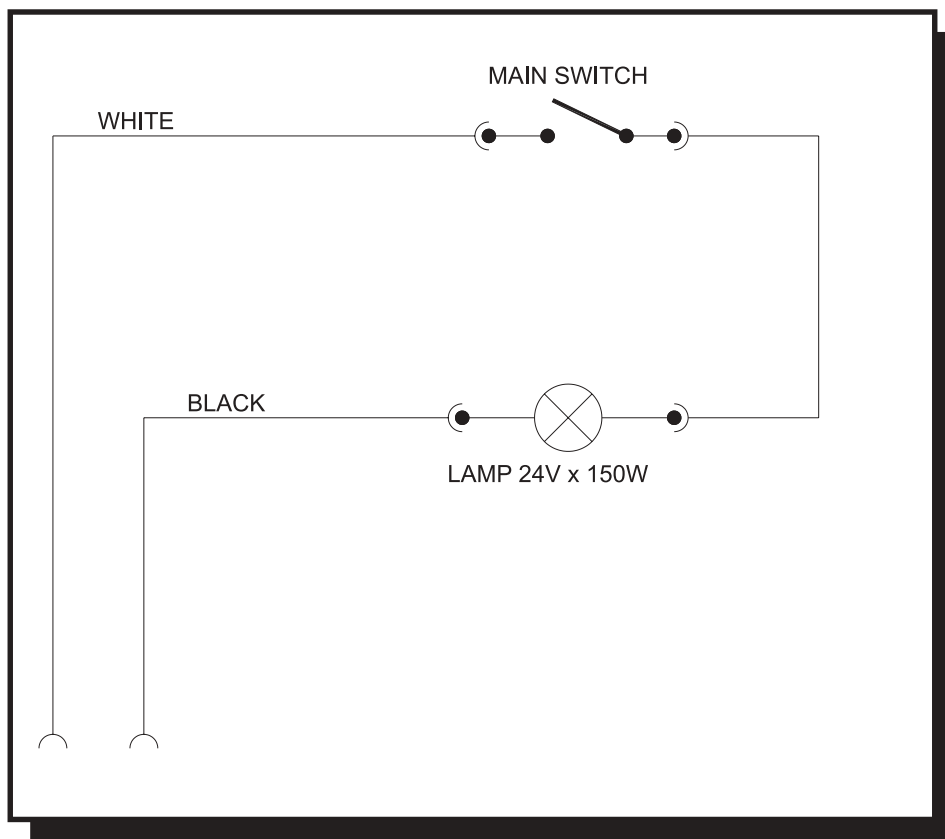

TROUBLESHOOTING

Abnormal situation	Possible causes	Solutions
- When the pedal control is pressed, the lamp does not turn on; Note: Consider that the electronic card and transformer are working.	<ul style="list-style-type: none">- Power cut;- Main switch is off;- Burnt chair's fuse;- Burnt lamp;- Lamp's cord incorrectly connected to card;- Luminosity adjusting wires incorrectly connected;- Lamp's support base is rusted.	<ul style="list-style-type: none">- Wait until the energy is back.- Turn the main switch on- Replace chair's fuse;- Replace lamp;- Connect wire(s); - Connect wire(s);- Clean rusted part.
-The lamp flickers	<ul style="list-style-type: none">-Lamp's bad contact;-Connection screw is loosened.	<ul style="list-style-type: none">- Replace terminal- Tighten screw