



SM-H0004_E Rev.1

SERVICE MANUAL

For UHR and VR series Straight Handpiece



Parts List No.

UHR35: D-079

UHR50T: D-061

UHR50C: D-062

VR: D-036

VR-E: D-082

NSK
NAKANISHI INC.

Notice

This manual applies to both UHR series and VR series.

UHR series and VR series are identical in construction, with only exception of the outer design and dimensions of the spindles; and same tools are used.

1. TOOLS REQUIRED



T-2 (Pliers)



Emery Cloth



DT-203



DT-145



DT-41



H124 751

(Angled Wrench (9mm))



T-35 (Hammer)



DT-179



DT-131



DT-267 (Vise)

Dummy Bur and Tweezers are required.

2. DISASSEMBLY PROCEDURE

Caution

Disassemble on a tray to prevent losing parts.

Replace the O-ring if any damages found during disassembling.

2-1 Remove the Nose Hood

Set DT-203 on the rear end of Bur Lock Ring. Align hollows of Spindle with slots of Nose Hood and slide H124-751 into the alignment. Hold H124-751 with T-2 and unscrew it to remove the Nose Hood from the Bur Lock Ring. By removing the Nose Hood, a Spindle Assembly, a F. Preload Spring Washer, a Preload Spring, and a Preload Spring Washer are drawn from the Bur Lock Ring.

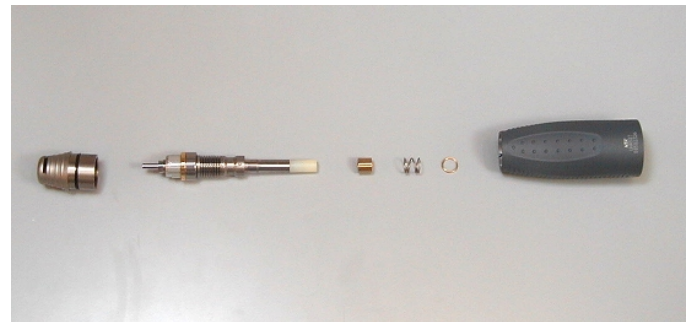
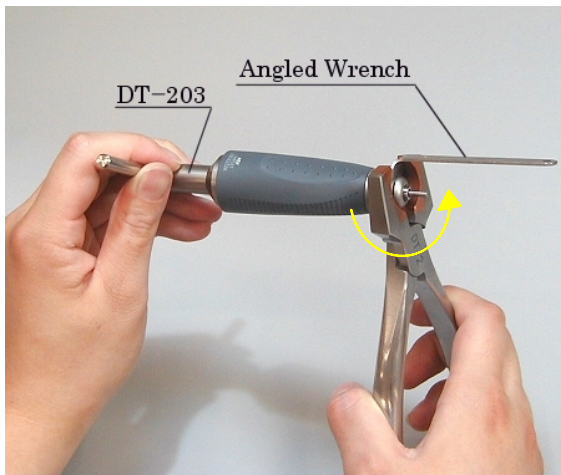

(In case of VR series)

Hold the Sheath Ass'y with T-2 on emery cloth between. Align hollows of Spindle with slots of Nose Hood and slide H124-751 into the alignment. Hold H124-751 with T-2 and unscrew it to remove the Nose Hood from the Sheath Ass'y.

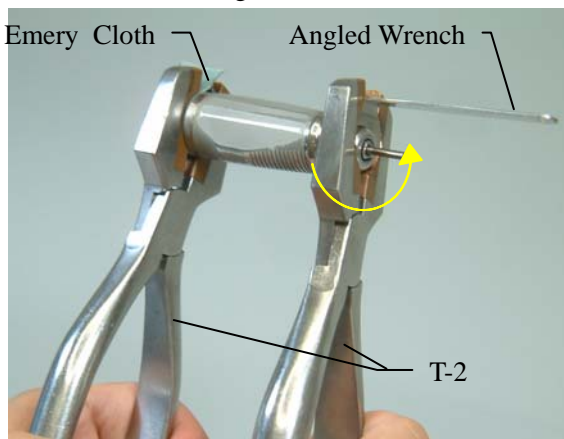

Only in case of VR-E, before removal of the Nose Hood, remove the Insert Joint.

Protect the Sheath Ass'y and the Insert Joint with emery cloth and turn counterclockwise with T-2 to remove the Insert Joint.

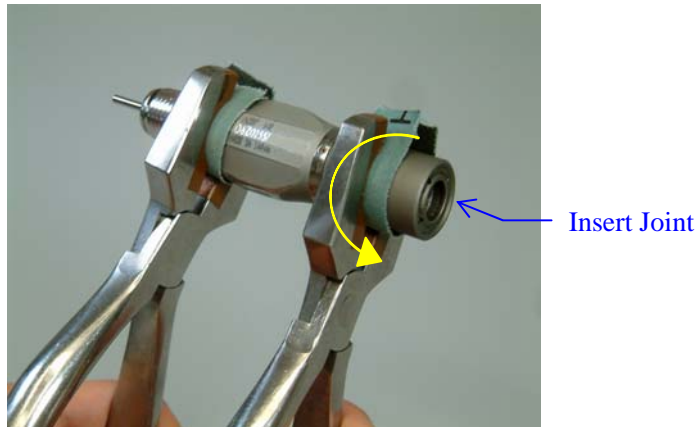

2-2 Remove the Rear Bearing

Insert DT-41 into the rear end of the Bur Lock Ring and unscrew R. Bearing Retainer Nut to remove Bearing. By removing a R. Bearing Retainer Nut, a Return Spring, a Return Spring Washer, and a Bearing are drawn from the Bur Lock Ring.

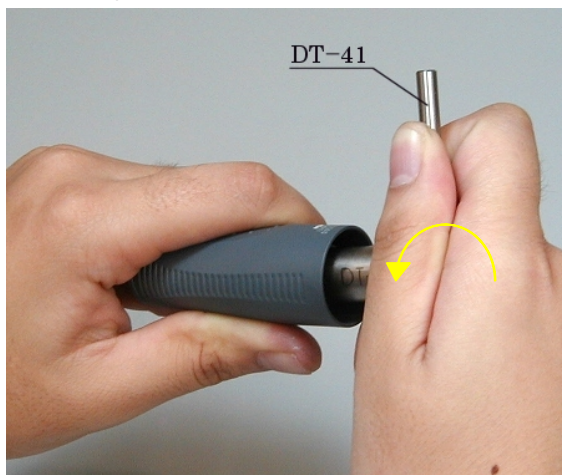

2-3 Remove the Slide Ring

Insert DT-145 into the Bur Lock Ring from front and unscrew Bur Lock Ring Retainer to remove Housing.

Slide out the Bur Lock Ring Retainer and the Housing. Remove two Balls and a Slide Ring from the Housing.

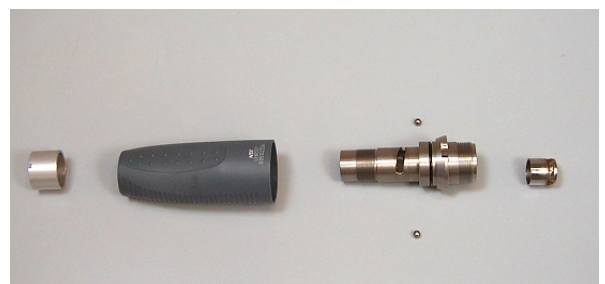
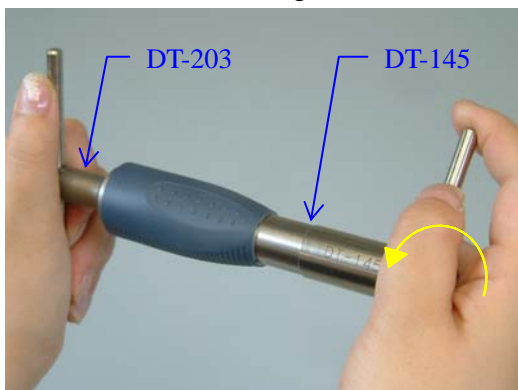

2-4 Disassemble the Spindle

Put DT-131 on the rear of the Spindle. Fix the Spindle with DT-267 (Vise) and compress it approximately 2mm.

Position the marked end on the Chuck Pin. Put DT-179 on it and tap the DT-179 with T-35 to push out the Chuck Pin from the Spindle.

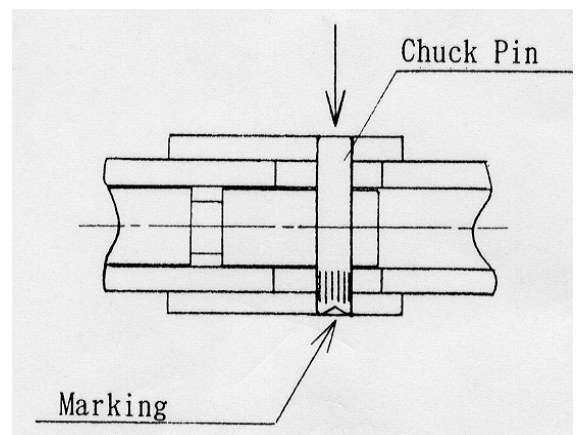
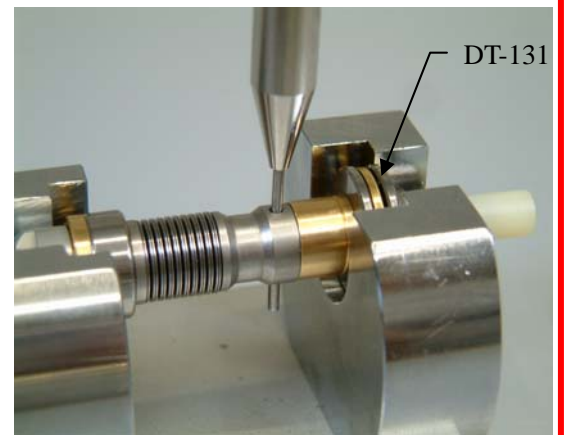
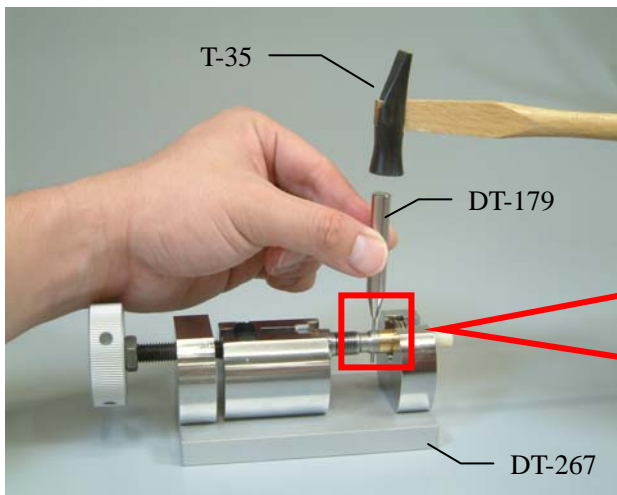

Cross Section

By removing the Chuck Pin, all components of the Spindle are disassembled.

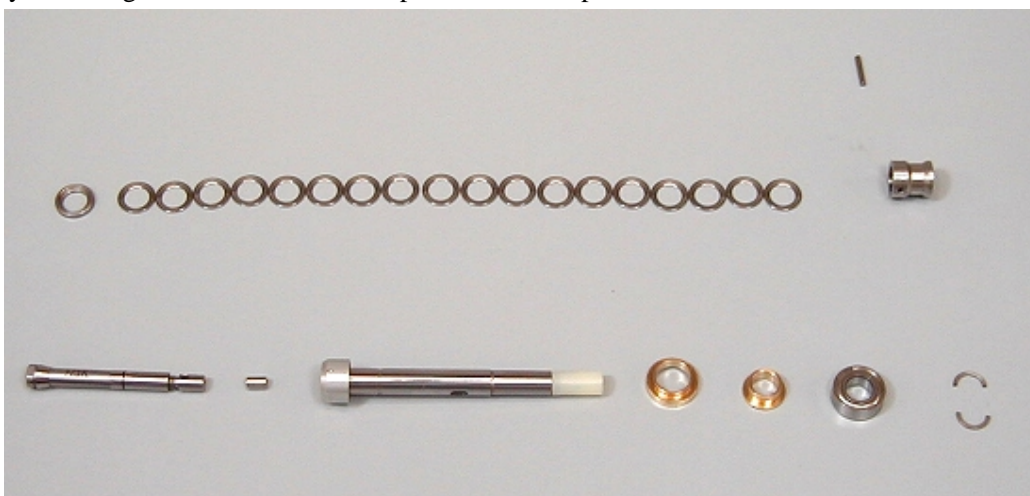

Please refer to the part list for the more detailed disassembly.

3. CAUTIONS FOR ASSEMBLING

Reverse the procedure for disassembly with following cautions, when assembling.

3-1 Assemble the Spindle

Screw Chuck Shaft into the Chuck completely and then turn the Shaft back by two threads.

Adjustment should be done after complete assembly of the Handpiece.

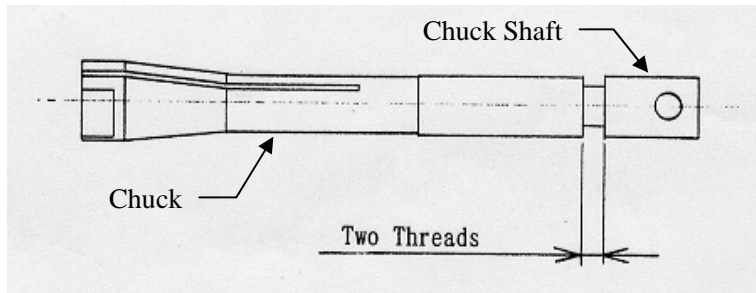

When drive the Chuck Pin into the Spindle, use new one.

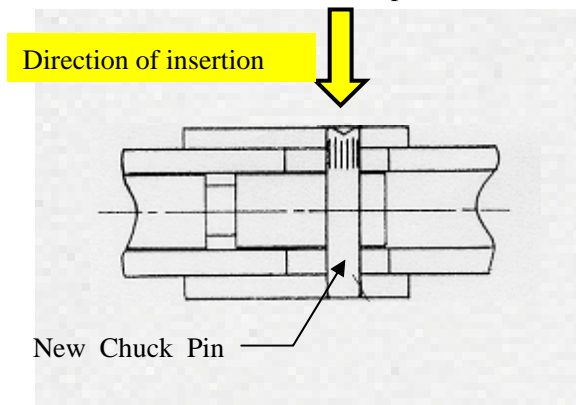

3-2 Assemble the Slide Ring

Insert the Slide Ring into the Housing and align a groove on the Slide Ring with slots on the Housing.

Confirm the direction of the Slide Ring.

Grease the groove and slots, and place a ball on the slot on each side.

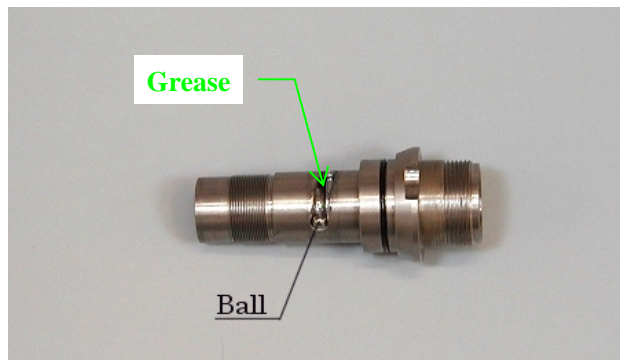
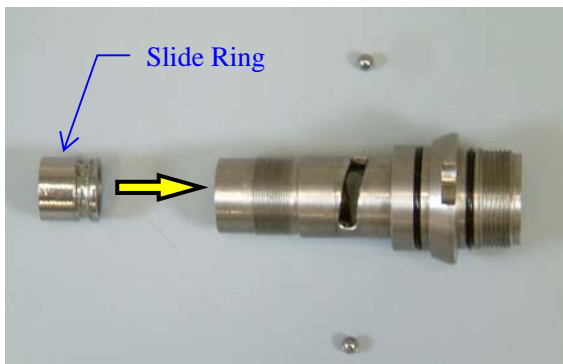

Look from the top of it and align the balls on the Housing with the hollows inside Bur Lock Ring. Insert the Housing into the Bur Lock Ring slowly.

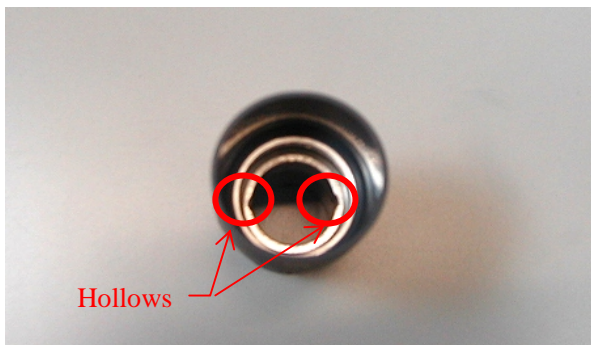

After the Slide Ring is set in the right position, mount the Bur Lock Ring Retainer securely, using the DT-145.

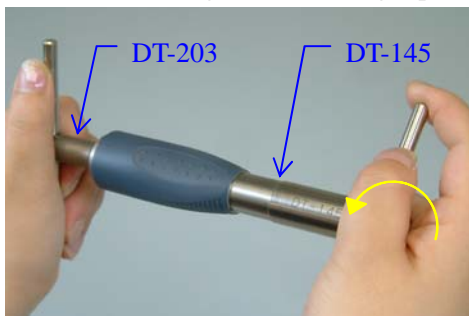

Then, assemble the remaining in the reverse order of disassembling.

NSK

NAKANISHI INC.
700 Shimohinata, Kanuma,
Tochigi 322-8666, Japan

www.nsk-inc.com

NSK AMERICA CORPORATION
700 Cooper Court, Schaumburg,
Illinois 60173, USA

www.nskamerica.com

NSK EUROPE GmbH
Westerbachstraße 58,
D-60489 Frankfurt, Germany

www.nsk-europe.de

