



SM-C0028_E

SERVICE MANUAL

For EX series Handpieces

EC-30 / E4R / E10R / E16R / E20RI / E64R etc



Notice

The photograph in the manual is a different product. But the design is only different.
Please advance it according to the following procedure.

1. TOOLS REQUIRED



T-2 (Pliers)



Emery Cloth



Stick etc

2. DISASSEMBLY PROCEDURE

Caution

Disassemble on a tray to prevent losing parts.

In case of EC-30

2-1 Removal of Sheath

Protect the Sheath and the Elbow Ass'y with Emery Cloth, turn counterclockwise with T-2 to remove the Sheath.

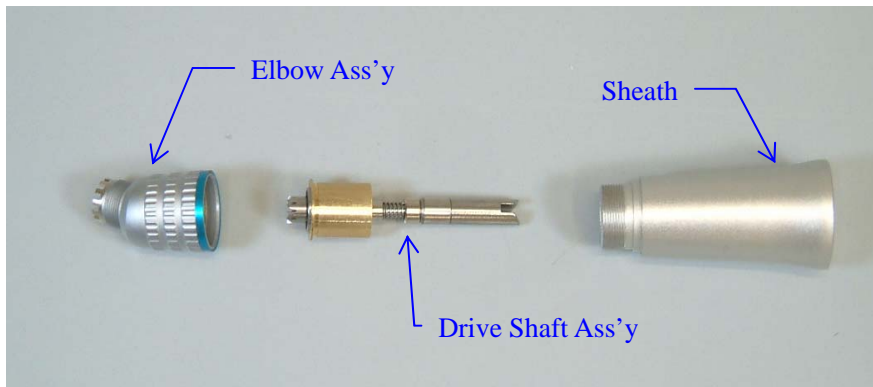
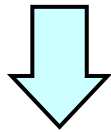
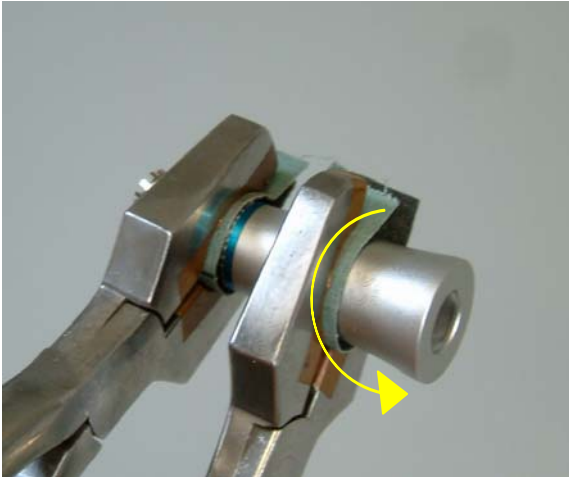

In case of E4R / E10R / E16R / E20RI / E64R etc

2-2 Removal of the Rear Joint

Protect the Sheath and the Rear Joint with Emery Cloth, turn counterclockwise with T-2 to remove the Sheath.

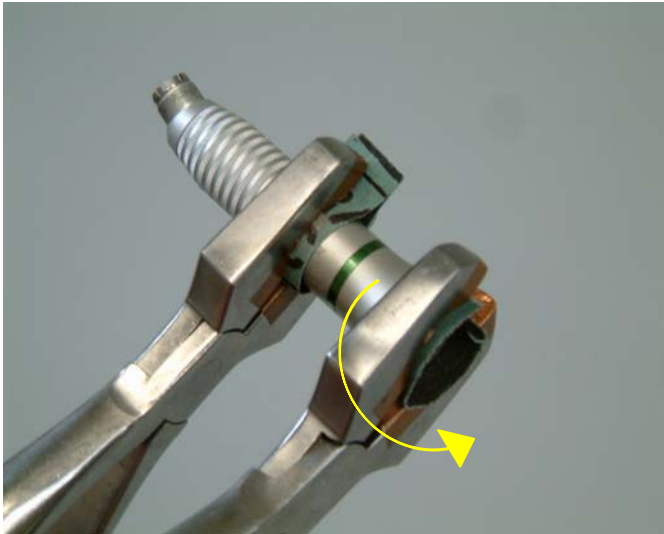

2-3 Removal of the Dog Clutch Shaft Ass'y

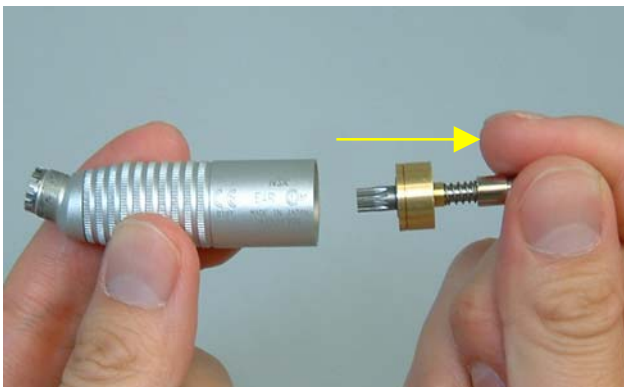

2-3 Removal of the Reduction Gear Ass'y

Push the the Reduction Gear Ass'y with Stick etc.

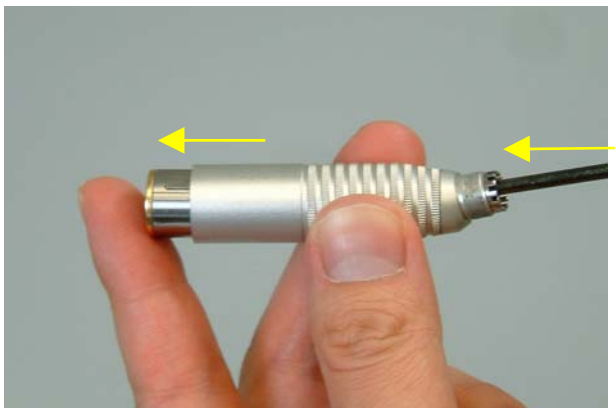

Please refer to the part list for the more detailed disassembly.

3. REASSEMBLY PROCEDURE

Reverse the procedure for disassembly.



NAKANISHI INC.
700 Shimohinata, Kanuma,
Tochigi 322-8666, Japan

www.nsk-inc.com

NSK AMERICA CORPORATION
700 Cooper Court, Schaumburg,
Illinois 60173, USA

www.nskamerica.com

NSK EUROPE GmbH
Westerbachstraße 58,
D-60489 Frankfurt, Germany

www.nsk-europe.de



Powerful Partners[®]